

INSTALLATION

Xmat™ MG 150

Thin Electric Heating Mat (c/w Single Cold Tail)

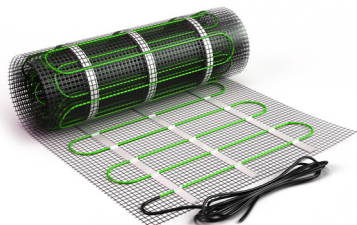

The following reference is for WET and DRY installs. This document details the recommended conduit installation method, and typical installation for Xmat MG-150 with a single cold tail.

ELECTRICAL REQUIREMENTS

- Determine the location of the thermostat and power supply.
- Ensure adequate power capacity and connection to RCD protection.
- Contactors are required for any individual zone over 12Amp.
- The supplied 10mm OD flexible conduit should be used for the thermostat sensor probe, and placed inside a rigid 20mm conduit. A separate 20mm conduit is required for each cold tail.

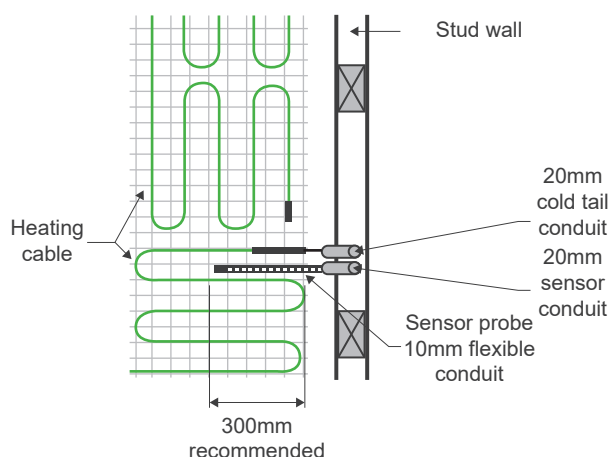

PLAN VIEW Looking down onto the floor

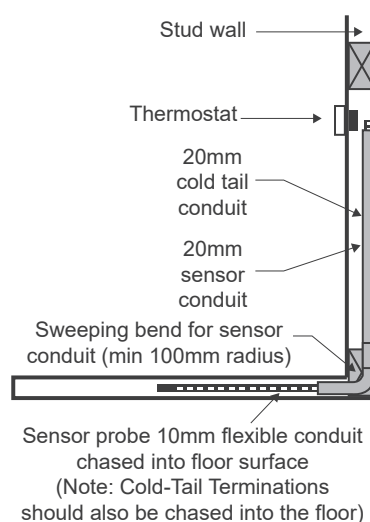

SECTION VIEW Looking from the side

KEY POINTS

- The entire heating element must be embedded in tile adhesive or a thin levelling bed, being sure to avoid air-pockets. Thermal insulation is recommended under the mats.
- The heating element must not be cut or shortened, however, their cold tails may be cut or extended. The cold tail termination to the heating elements must be embedded in the floor.
- All heating mats are to be installed under the supervision of a licensed electrician, and must be RCD protected. The outer screen of each heating element must be earthed.
- The switchboard / distribution board must clearly identify the floor heating installation location and detail.
- Failure to comply with the full installation guide will void the warranty.

p: 1800 636 091 | e: info@devexsystems.com.au | w: www.devexsystems.com.au

STEP-BY-STEP GUIDE



Step 1

Xmat heating system

- Xmat heating mat
- Thermostat (with floor sensor)
- Sensor flexible conduit (10mm)



Step 2

Draw a plan showing the actual heated area, heating mat, cold tail location, floor sensor position, thermostat and connection box (if any).



Step 3

Glue appropriate thermal insulation onto the sub-floor (e.g. F-Board) in accordance with the product installation specifications. Allow glue to dry (min. 24 hours). Cut a groove for the sensor and terminations, ensuring the sensor extends a minimum of 30cm into the heated area.



Step 4

Clean and vacuum the floor. Install sensor conduit (10mm OD) into the groove. Tape the end to avoid glue ingress. Prime floor surface with Ardex Multiprime* or similar.



Step 5

Check the heating mat cable resistance and its insulation resistance values. Roll out the mat onto the floor from the thermostat position, sticky side down.



Step 6

The mesh mat can be cut to go around fixtures and to cover the floor area to be heated. DO NOT CUT the heating element.



Step 7

Layout the Xmat being sure to avoid all obstacles and fixtures. Minimum spacing of 50mm between any two heating elements.

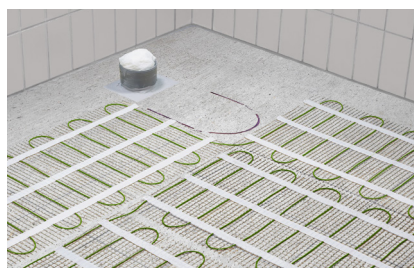

Step 8

Lay out entirety of the mat noting that the heating cable cannot be shortened. Check the cable resistance and insulation values again before applying leveller. Photograph installation and meter readings. Note that the cold-tail termination(s) must be embedded in the floor.



Step 9

Coat Xmat with Ardex* leveller (2 part) or similar. Allow to dry and prime leveller with Ardex multi-prime*. Waterproof with Ardex WRM155* & STB tape accordingly. Allow to dry. Fix tiles with Ardex X18* or X68* (or similar). Reconfirm cable resistance and insulation values.

IMPORTANT NOTES

- Read the installation guide supplied with the heating mats and thermostats for any specific requirements relating to your installation.
- The heating cables must be securely attached to the floor before applying tile adhesive or levelling beds so that the cable cannot lift or vary its spacing. Air pockets around the cables must be prevented.
- The heating mat must never touch or cross over each other or failure is likely.
- Not complying with the full guide will void the warranty.
- Please contact Devex Systems (phone 1800 636 091) if unsure of any aspect of the installation.

* References to specific brands of tile adhesives and levelling compounds are offered as recommendations only. Tiling trade professionals are encouraged to seek advice from their preferred adhesive manufacturers in relation to product selection and suitability over floor heating systems.

